

KNURLED THUMB SCREWS

INCH/
METRIC

Material: 303 Stainless steel.

ORDER BY CATALOG NUMBER

For heavy head screws see products JKS-B1.

Nylon Points available upon request

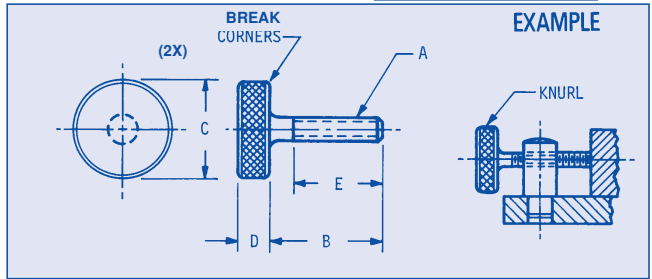

A	B	C	D	E	Cat. No.	A	B	C	D	E	Cat. No.
# 4-40	3/8	1/4	1/8	5/16	JKS-A1-1	#10-24	1-1/4	3/4	3/16	1	JKS-A1-26
	1/2	1/4	1/2	7/16	JKS-A1-2		1-1/2			1-1/4	JKS-A1-27
	3/4	1/4	1/2	5/8	JKS-A1-3		1/2	3/8		7/16	JKS-A1-28
	3/8	3/8	1/8	5/16	JKS-A1-4		3/4			5/8	JKS-A1-29
	1/2	3/8	1/8	7/16	JKS-A1-5		1			13/16	JKS-A1-30
# 6-32	1/2	1/4	1/2	7/16	JKS-A1-6	#10-32	1-1/4		3/16	1	JKS-A1-31
	3/4	1/4	1/2	5/8	JKS-A1-7		3/4	1/2		5/8	JKS-A1-32
	1	1/4	1/2	13/16	JKS-A1-8		1			13/16	JKS-A1-33
	3/8	3/8	1/8	5/16	JKS-A1-9		1-1/4			1	JKS-A1-34
# 8-32	1/2	1/4	1/2	7/16	JKS-A1-11	1/4-20	1-1/2			1-1/4	JKS-A1-35
	3/4	1/4	1/2	5/8	JKS-A1-12		3/4	3/4		5/8	JKS-A1-36
	1	1/4	1/2	13/16	JKS-A1-13		1			13/16	JKS-A1-37
	3/8	3/8	1/8	5/16	JKS-A1-14		1-1/4			1	JKS-A1-38
	1/2	3/8	1/8	3/8	JKS-A1-15		1-1/2			1-1/4	JKS-A1-39
#10-24	1/2	3/8	3/16	7/16	JKS-A1-16	1/4-20	3/4	3/4	3/16	5/8	JKS-A1-40
	3/4			JKS-A1-17	13/16		JKS-A1-18			1	JKS-A1-41
	1			JKS-A1-19	1		JKS-A1-20			1-1/4	JKS-A1-42
	1-1/4			JKS-A1-21	5/8		JKS-A1-22			1-1/2	JKS-A1-43
	1	JKS-A1-22		13/16	JKS-A1-23		2	JKS-A1-44			
	1-1/4	JKS-A1-23		1			3/4	JKS-A1-45			
	1-1/2			1-1/4			1	JKS-A1-46			
3/4	3/4	5/8	JKS-A1-24	1-1/4	JKS-A1-47						
1		13/16	JKS-A1-25	2	JKS-A1-48						
									1-1/4	JKS-A1-49	
									1-5/8	JKS-A1-49	

METRIC SIZES

Material: 303 Stainless steel.

ORDER BY CATALOG NUMBER

Dimensions in millimeters

Thread Size	Cat. No.	B	C	D	E	Thread Size	Cat. No.	B	C	D	E		
M3 x 5	JKS-M1-1	12,0		3	8,0	M5 x 8	JKS-M1-15	25,0	12,0	5,0	16,0		
	JKS-M1-2	25,0	7,0	12	11,0		JKS-M1-16	30,0			20,0		
	JKS-M1-3	32,0		12	16,0		JKS-M1-17	36,0			25,0		
M3 x 5	JKS-M1-4	12,0	10,0	3	8,0	M5 x 8	JKS-M1-18	42,0			32,0		
	JKS-M1-5	16,0		3	11,0		JKS-M1-19	25,0			16,0		
M4 x 7	JKS-M1-6	25,0	7,0	12	11,0		JKS-M1-20	30,0	19,0	5,0	20,0		
	JKS-M1-7	32,0		12	16,0		JKS-M1-21	36,0			25,0		
M4 x 7	JKS-M1-8	38,0		12	24,0		JKS-M1-22	42,0			32,0		
	JKS-M1-9	12,0	10,0	3	8,0	M6 x 1,0	JKS-M1-23	25,0	19,0	5,0	16,0		
M5 x 8	JKS-M1-10	16,0		3	10,0		JKS-M1-24	30,0					20,0
	JKS-M1-11	18,0		5	11,0		JKS-M1-25	36,5					25,0
	JKS-M1-12	25,0	10,0	5	16,0	JKS-M1-26	42,5			32,0			
	JKS-M1-13	30,0		5	20,0	JKS-M1-27	25,0	25,5	5,0	16,0			
	JKS-M1-14	36,0		5	25,0	JKS-M1-28	30,0					20,0	
				5	25,0	JKS-M1-29	36,5					25,0	
						JKS-M1-30	42,0			32,0			

* Other lengths available on request

NORDEX

(800) 243-0986
In CT (203) 775-4877

8J

KNURLED THUMB SCREWS

**#4-40 TO
#10-32**

HEAVY HEAD

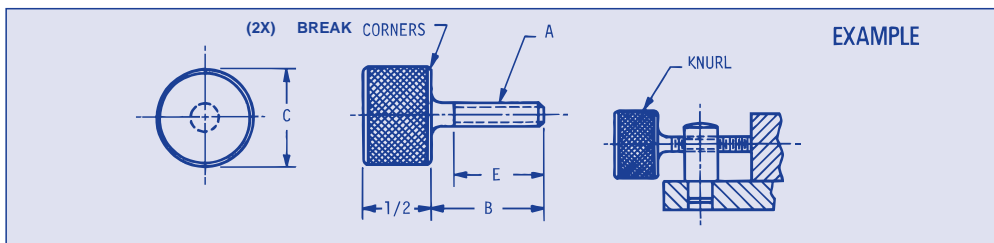

ORDER BY CATALOG NUMBER

Material: 303 Stainless steel.

NYLON POINTS AVAILABLE UPON REQUEST

A	B	C	E	Cat. No.	A	B	C	E	Cat. No.
# 4-40	3/8	3/8	5/16	JKS-B1-1	#10-24	3/4	3/8	5/8	JKS-B1-8
# 4-40	1/2	3/8	7/16	JKS-B1-2	#10-24	1	3/8	13/16	JKS-B1-9
# 6-32	3/8	3/8	5/16	JKS-B1-3	#10-24	1-1/4	3/8	1	JKS-B1-10
# 6-32	1/2	3/8	3/8	JKS-B1-4	#10-32	1/2	3/8	7/16	JKS-B1-11
# 8-32	3/8	3/8	5/16	JKS-B1-5	#10-32	3/4	3/8	5/8	JKS-B1-12
# 8-32	1/2	3/8	3/8	JKS-B1-6	#10-32	1	3/8	13/16	JKS-B1-13
#10-24	1/2	3/8	7/16	JKS-B1-7	#10-32	1-1/4	3/8	1	JKS-B1-14

KNURLED THUMB SCREWS

SOCKET HEAVY HEAD

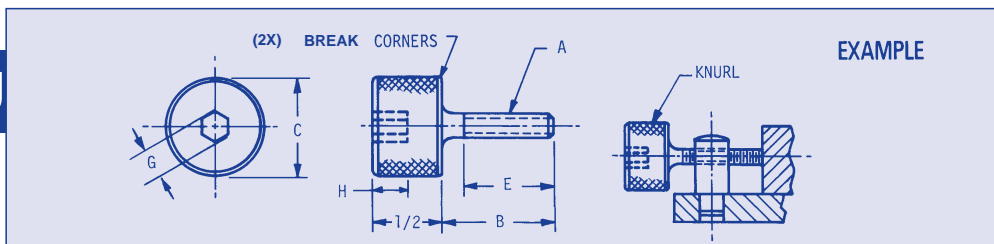

ORDER BY CATALOG NUMBER

Material: 303 Stainless steel.

NYLON POINTS AVAILABLE UPON REQUEST

A	B	C	E	G	MIN. H	Cat. No.	A	B	C	E	G	H	Cat. No.
# 4-40	1/2	1/4	7/16	5/64	1/16	JKS-C1-1	# 8-32	1	1/4	13/16	5/64	1/16	JKS-C1-12
# 4-40	3/4	1/4	5/8	5/64	1/16	JKS-C1-2	# 8-32	3/8	3/8	5/16	1/8	3/32	JKS-C1-13
# 4-40	3/8	3/8	5/16	1/8	3/32	JKS-C1-3	# 8-32	1/2	3/8	3/8	1/8	3/32	JKS-C1-14
# 4-40	1/2	3/8	7/16	1/8	3/32	JKS-C1-4	#10-24	1/2	3/8	7/16	1/8	3/32	JKS-C1-15
#6-32	1/2	1/4	7/16	5/64	1/16	JKS-C1-5	#10-24	3/4	3/8	5/8	1/8	3/32	JKS-C1-16
# 4-40	3/4	1/4	5/8	5/64	1/16	JKS-C1-6	#10-24	1	3/8	13/16	1/8	3/32	JKS-C1-17
#6-32	1	1/4	13/16	5/64	1/16	JKS-C1-7	#10-24	1-1/4	3/8	1	1/8	3/32	JKS-C1-18
#6-32	3/8	3/8	5/16	1/8	3/32	JKS-C1-8	#10-32	1/2	3/8	7/16	1/8	3/32	JKS-C1-19
#6-32	1/2	3/8	3/8	1/8	3/32	JKS-C1-9	#10-32	3/4	3/8	5/8	1/8	3/32	JKS-C1-20
#8-32	1/2	1/4	7/16	5/64	1/16	JKS-C1-10	#10-32	1	3/8	13/16	1/8	3/32	JKS-C1-21
#8-32	3/4	1/4	5/8	5/64	1/16	JKS-C1-11	#10-32	1-1/4	3/8	1	1/8	3/32	JKS-C1-22

KNURLED THUMB SCREWS

**5/16 HEAD
SIZE**

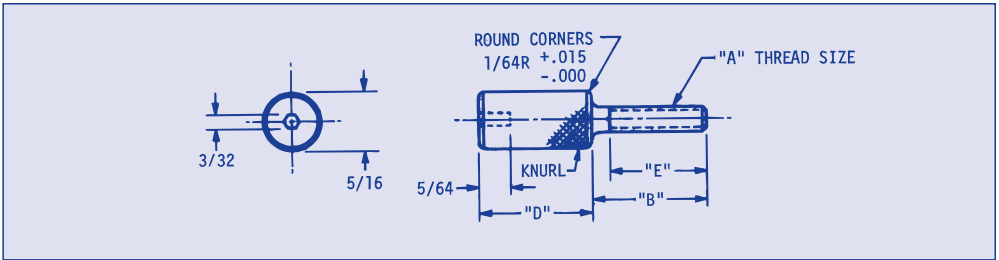

Material: 303 Stainless steel.

ORDER BY CATALOG NUMBER

Cat. No.	A	B	D	E	Cat. No.	A	B	D	E
JKS-D1-1 JKS-D1-2	#4-40	1/2 3/4	1/2	7/16 5/8	JKS-D1-9 JKS-D1-10 JKS-D1-11 JKS-D1-12	#10-24	1/2 3/4 1 1-1/4	3/16	7/16 5/8 13/16 1
JKS-D1-3 JKS-D1-4 JKS-D1-5	#6-32	1/2 3/4 1	1/2	7/16 5/8 13/16	JKS-D1-13 JKS-D1-14 JKS-D1-15 JKS-D1-16	#10-32	1/2 3/4 1 1-1/4	3/16	7/16 5/8 13/16 1
JKS-D1-6 JKS-D1-7 JKS-D1-8	#8-32	1/2 3/4 1	1/2	7/16 5/8 13/16					

KNURLED THUMB SCREWS

**5/16 HEAD
SIZE**

HEAVY HEAD

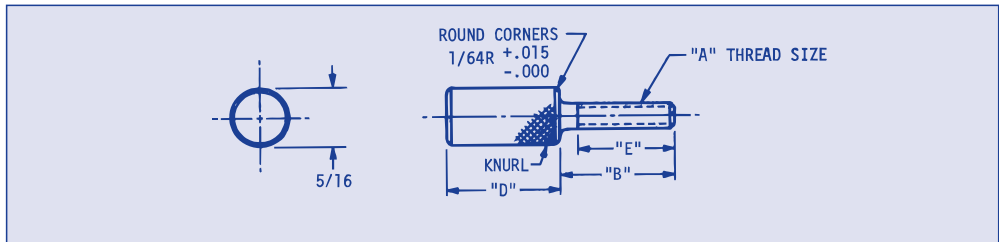

Material: 303 Stainless steel.

ORDER BY CATALOG NUMBER

Cat. No.	A	B	D	E	Cat. No.	A	B	D	E
JKS-E1-1 JKS-E1-2 JKS-E1-3	#4-40	3/8 1/2 3/4	1/8 1/2 1/2	5/16 7/16 5/8	JKS-E1-12 JKS-E1-13	#8-32	3/8 1/2	1/8 1/8	5/16 3/8
JKS-E1-4 JKS-E1-5 JKS-E1-6 JKS-E1-7 JKS-E1-8	#6-32	1/2 3/4 1 3/8 1/2	1/2 1/2 1/2 1/8 1/8	7/16 5/8 13/16 5/16 3/8	JKS-E1-14 JKS-E1-15 JKS-E1-16 JKS-E1-17	#10-24	1/2 3/4 1 1-1/4	3/16	7/16 5/8 13/16 1
JKS-E1-9 JKS-E1-10 JKS-E1-11	#8-32	1/2 3/4 1	1/2 1/2 1/2	7/16 5/8 13/16	JKS-E1-18 JKS-E1-19 JKS-E1-20 JKS-E1-21	#10-32	1/2 3/4 1 1-1/4	3/16	7/16 5/8 13/16 1

NORDEX

(800) 243-0986
In CT (203) 775-4877

10J

PLASTIC HEAD THUMB SCREWS

THREAD SIZES
#4-40-#1/4-20

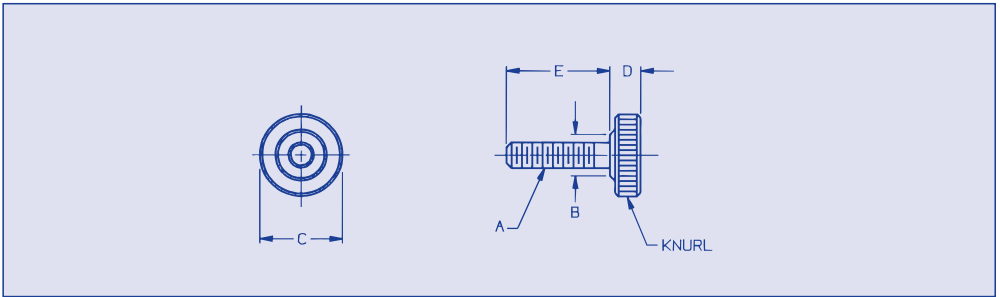

Material: KNURLED HEAD - Black Plastic
SCREW - 300 Series Stainless Steel.

SPECIAL SIZES AVAILABLE ON REQUEST

ORDER BY CATALOG NUMBER

Cat. No.	A	B	C	D	E
JKX-F1-1 JKX-F1-2 JKX-F1-3 JKX-F1-4 JKX-F1-5	#4-40	9/32	5/16	11/64	1/4 5/16 3/8 1/2 5/8
JKX-F1-6 JKX-F1-7 JKX-F1-8 JKX-F1-9 JKX-F1-10	#6-32	21/64	3/8	3/16	5/16 3/8 1/2 5/8 3/4
JKX-F1-11 JKX-F1-12 JKX-F1-13 JKX-F1-14 JKX-F1-15	#8-32	3/8	1/2	7/32	3/8 1/2 5/8 3/4 1
JKX-F1-16 JKX-F1-17 JKX-F1-18 JKX-F1-19 JKX-F1-20	#10-24	27/64	5/8	1/4	3/8 1/8 5/8 3/4 1
JKX-F1-21 JKX-F1-22 JKX-F1-23 JKX-F1-24 JKX-F1-25	#10-32		5/8		3/8 1/2 5/8 3/4 1
JKX-F1-26 JKX-F1-27 JKX-F1-28 JKX-F1-29 JKX-F1-30	#1/4-20	1/2	3/4	5/16	3/8 1/2 5/8 3/4 1
JKX-F1-31 JKX-F1-32 JKX-F1-33 JKX-F1-34 JKX-F1-35			1		3/8 1/2 5/8 3/4 1