

NYLON SCREWS, WASHERS & NUTS

PAN HEAD

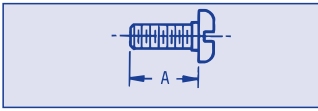

SOCKET HEAD

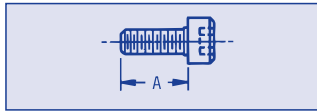

FLAT HEAD

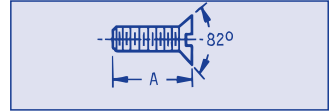

Material: Molded nylon (natural)

ORDER BY CATALOG NUMBER

D

Thread Size	A	CATALOG NUMBER			Thread Size	A	CATALOG NUMBER		
		Pan Head	Socket Head	Flat Head			Pan Head	Socket Head	Flat Head
#4-40	1/4	DON-A1-1	DON-A2-1	DON-A3-1	#10-24	1/4	DON-A1-17	DON-A2-17	DON-A3-17
	5/16	DON-A1-2	DON-A2-2	DON-A3-2		5/16	DON-A1-18	DON-A2-18	DON-A3-18
	3/8	DON-A1-3	DON-A2-3	DON-A3-3		3/8	DON-A1-19	DON-A2-19	DON-A3-19
	1/2	DON-A1-4	DON-A2-4	DON-A3-4		1/2	DON-A1-20	DON-A2-20	DON-A3-20
	3/4	DON-A1-5	DON-A2-5	DON-A3-5		3/4	DON-A1-21	DON-A2-21	DON-A3-21
#6-32	1/4	DON-A1-6	DON-A2-6	DON-A3-6	#10-32	1/4	DON-A1-23	DON-A2-23	DON-A3-23
	5/16	DON-A1-7	DON-A2-7	DON-A3-7		5/16	DON-A1-24	DON-A2-24	DON-A3-24
	3/8	DON-A1-8	DON-A2-8	DON-A3-8		3/8	DON-A1-25	DON-A2-25	DON-A3-25
	1/2	DON-A1-9	DON-A2-9	DON-A3-9		1/2	DON-A1-26	DON-A2-26	DON-A3-26
	3/4	DON-A1-10	DON-A2-10	DON-A3-10		3/4	DON-A1-27	DON-A2-27	DON-A3-27
#8-32	1/4	DON-A1-11	DON-A2-11	DON-A3-11	#1/4-20	1/4	DON-A1-29	DON-A2-29	DON-A3-29
	5/16	DON-A1-12	DON-A2-12	DON-A3-12		3/8	DON-A1-30	DON-A2-30	DON-A3-30
	3/8	DON-A1-13	DON-A2-13	DON-A3-13		7/16	DON-A1-31	DON-A2-31	DON-A3-31
	1/2	DON-A1-14	DON-A2-14	DON-A3-14		1/2	DON-A1-32	DON-A2-32	DON-A3-32
	3/4	DON-A1-15	DON-A2-15	DON-A3-15		3/4	DON-A1-33	DON-A2-33	DON-A3-33
	1	DON-A1-16	DON-A2-16	DON-A3-16		1	DON-A1-34	DON-A2-34	DON-A3-34

WASHER

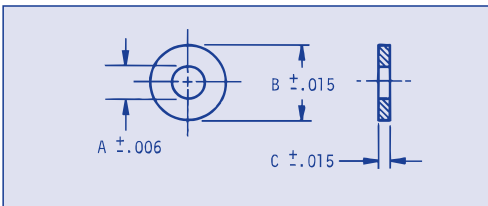

NUT

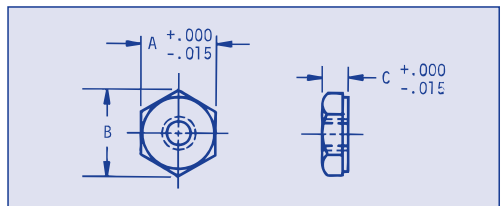

Material: Molded nylon (natural)

ORDER BY CATALOG NUMBER

Screw Size	A	B	C	Cat. No.	Thread Size	A	B	C	Cat. No.
#4	.115	.281	.047	DPN-A1-1	#4-40	.2500	.289	.098	DQN-A1-1
#6	.140	.312	.047	DPN-A1-2	#6-32	.3125	.361	.114	DQN-A1-2
#8	.170	.375	.062	DPN-A1-3	#8-32	.3438	.397	.130	DQN-A1-3
#10	.200	.437	.062	DPN-A1-4	#10-24	.3750	.433	.130	DQN-A1-4
1/4	.260	.562	.062	DPN-A1-5	#10-32	.3750	.433	.130	DQN-A1-5
					1/4-20	.4375	.505	.226	DQN-A1-6