

SOCKET HEAD SHOULDER SCREWS

METRIC

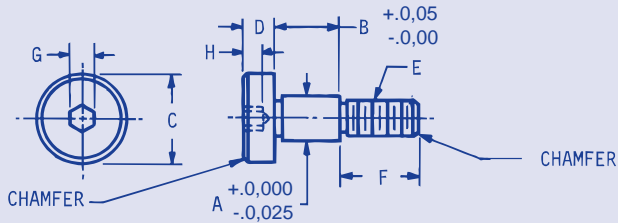

All dimensions in millimeters.
Threads are to ISO standards.

For Hex Keys, please inquire.

303 Stainless Steel	416 Stainless Steel Hardened RC 25-36	A	B	C	D	E	F	G	H
DAS-M1-1 DAS-M1-2 DAS-M1-3 DAS-M1-4 DAS-M1-5	DAS-M2-1 DAS-M2-2 DAS-M2-3 DAS-M2-4 DAS-M2-5	3,987 (4)	4,013 5,013 6,013 8,013 10,013	6	3	M3 x 0,5	4	2	1,6
DAS-M1-6 DAS-M1-7 DAS-M1-8 DAS-M1-9 DAS-M1-10 DAS-M1-11 DAS-M1-12 DAS-M1-13 DAS-M1-14 DAS-M1-15 DAS-M1-16	DAS-M2-6 DAS-M2-7 DAS-M2-8 DAS-M2-9 DAS-M2-10 DAS-M2-11 DAS-M2-12 DAS-M2-13 DAS-M2-14 DAS-M2-15 DAS-M2-16	4,987 (5)	4,013 5,013 6,013 8,013 10,013 12,013 14,013 16,013 20,013 25,013 30,013	8	4	M4 x 0,7	5	2,5	2
DAS-M1-17 DAS-M1-18 DAS-M1-19 DAS-M1-20 DAS-M1-21 DAS-M1-22 DAS-M1-23 DAS-M1-24 DAS-M1-25 DAS-M1-26 DAS-M1-27	DAS-M2-17 DAS-M2-18 DAS-M2-19 DAS-M2-20 DAS-M2-21 DAS-M2-22 DAS-M2-23 DAS-M2-24 DAS-M2-25 DAS-M2-26 DAS-M2-27	5,987 (6)	4,013 5,013 6,013 8,013 10,013 12,013 14,013 16,013 20,013 25,013 30,013	10	5	M5 x 0,8	6	3	2,4
DAS-M1-28 DAS-M1-29 DAS-M1-30 DAS-M1-31 DAS-M1-32 DAS-M1-33	DAS-M2-28 DAS-M2-29 DAS-M2-30 DAS-M2-31 DAS-M2-32 DAS-M2-33	7,987 (8)	6,013 8,013 10,013 12,013 16,013 20,013	12	6	M6 x 1	11	4	3,2
DAS-M1-34 DAS-M1-35 DAS-M1-36 DAS-M1-37	DAS-M2-34 DAS-M2-35 DAS-M2-36 DAS-M2-37	9,987 (10)	8,013 10,013 12,013 16,013	12	6	M6 x 1	11	4	3,2
DAS-M1-38 DAS-M1-39 DAS-M1-40 DAS-M1-41	DAS-M2-38 DAS-M2-39 DAS-M2-40 DAS-M2-41	9,987 (10)	8,013 10,013 12,013 16,013	14	7	M8 x 1,25	12	5	4
DAS-M1-42 DAS-M1-43 DAS-M1-44 DAS-M1-45	DAS-M2-42 DAS-M2-43 DAS-M2-44 DAS-M2-45	11,987 (12)	12,013 16,013 20,013 25,013	20	8	M10 x 1,5	16	6	4,8