

# SOCKET HEAD SHOULDER SCREWS

INCH

PRECISION

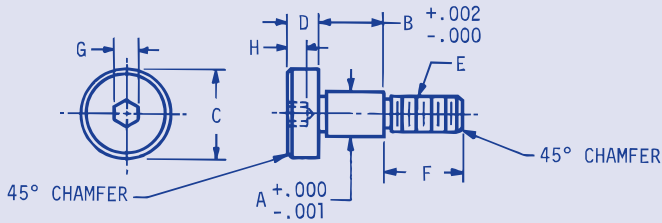

D

303 Stainless Steel	416 Stainless Steel Hardened RC 25-36	For Hex Keys, please see DGC series.								ORDER BY CATALOG NUMBER
Cat. No.	Cat. No.	A	B	C	D	E	F	G	H	
DBS-A1-1 DBS-A1-2 DBS-A1-3 DBS-A1-4 DBS-A1-5	DBS-B2-1 DBS-B2-2 DBS-B2-3 DBS-B2-4 DBS-B2-5	1/8 (.1245)	.1255 .1880 .2505 .3130 .3755	1/4	1/8	#4-40	5/32	5/64	1/16	
DBS-A1-6 DBS-A1-7 DBS-A1-8 DBS-A1-9 DBS-A1-10 DBS-A1-11 DBS-A1-12 DBS-A1-13 DBS-A1-14 DBS-A1-15 DBS-A1-16	DBS-B2-6 DBS-B2-7 DBS-B2-8 DBS-B2-9 DBS-B2-10 DBS-B2-11 DBS-B2-12 DBS-B2-13 DBS-B2-14 DBS-B2-15 DBS-B2-16	3/16 (.1870)	.1255 .1880 .2505 .3130 .3755 .5005 .6255 .7505 1.0005 1.2505 1.5005	5/16	5/32	#8-32	3/16	3/32	5/64	
DBS-A1-17 DBS-A1-18 DBS-A1-19 DBS-A1-20 DBS-A1-21 DBS-A1-22 DBS-A1-23 DBS-A1-24 DBS-A1-25 DBS-A1-26 DBS-A1-27	DBS-B2-17 DBS-B2-18 DBS-B2-19 DBS-B2-20 DBS-B2-21 DBS-B2-22 DBS-B2-23 DBS-B2-24 DBS-B2-25 DBS-B2-26 DBS-B2-27	1/4 (.2495)	.1255 .1880 .2505 .3130 .3755 .5005 .6255 .7505 1.0005 1.2505 1.5005	3/8	3/16	#10-32	1/4	1/8	3/32	
DBS-A1-28 DBS-A1-29 DBS-A1-30 DBS-A1-31 DBS-A1-32 DBS-A1-33	DBS-B2-28 DBS-B2-29 DBS-B2-30 DBS-B2-31 DBS-B2-32 DBS-B2-33	5/16 (.3120)	.2505 .3130 .3755 .5005 .6255 .7505	1/2	7/32	1/4-20	7/16	5/32	1/8	
DBS-A1-34 DBS-A1-35 DBS-A1-36 DBS-A1-37	DBS-B2-34 DBS-B2-35 DBS-B2-36 DBS-B2-37	3/8 (.3745)	.3130 .3755 .5005 .6255	1/2	7/32	1/4-20	7/16	5/32	1/8	
DBS-A1-38 DBS-A1-39 DBS-A1-40 DBS-A1-41	DBS-B2-38 DBS-B2-39 DBS-B2-40 DBS-B2-41	3/8 (.3745)	.3130 .3755 .5005 .6255	9/16	1/4	5/16-18	1/2	3/16	5/32	
DBS-A1-42 DBS-A1-43 DBS-A1-44 DBS-A1-45	DBS-B2-42 DBS-B2-43 DBS-B2-44 DBS-B2-45	1/2 (.4995)	.5005 .6255 .7505 1.0005	3/4	5/16	3/8-16	5/8	1/4	3/16	

NORDEX

(800) 243-0986  
In CT (203) 775-4877

4D